

General information

PWS6020240318

UWT 600 is a reliable weight transmitter that guarantees high performance. The product is customizable and can be equipped with different options depending on the purpose of use. Among the various options we find: the analogue output and the possibility to configure the instrument with 2 options at the same time. The weight transmitter UWT 600 has a keypad with 4 membrane keys and screw terminal screw.



Technical Manual: [uwt-600_en.pdf](#)

All indicated data may be changed without notice.
All the measures indicated are expressed in millimeters (mm).

Technical specifications

PWS6020240318

Measuring range:	-1.5 ÷ +3.5 mV/V
Input sensitivity:	0.02 µV/count
Full scale non-Linearity:	÷0.01%
Gain drift:	± 0.001% FS/°C
Display:	Alphanumeric backlit LCD, 2 lines and 16 scripts
A/D Converter:	24 bit
Internal Resolution:	> 16.000.000 counts
Transducer input voltage:	5 V (max 6 load cells 350 Ohm)
Visible resolution (in divisions):	600000
Divisions value (adjustable):	x1, x2, x5
Decimal figures range:	0 ÷ 3
Temperature range:	-10 ÷ +50°C (max umidity 85% without condensation)
Storage temperature:	-20 ÷ +70°C
Filter:	0.1 ÷ 25 Hz
Logic output:	2 outputs (NA) - 115 Vca/30 Vcc, 0.5 A
Logic input:	2 optoisolated 24 V cc PNP
Serial port:	COM1: RS232 COM2: RS422/RS485
Power supply:	24 Vcc ±15% - 12 W
Regulatory compliance:	EN61000, EN61000 for EMC; EN61010-1 for electrical safety
Baud rate:	1200 ÷ 115200 adjustable
Transmission distance:	15m (RS232C), 1000m (RS422; RS485)
Dimensions:	100 x 75 x 110 mm (L x H x D)
Fieldbus:	ASCII, Modbus RTU, Profibus, Devicenet, Ethernet (optional)

All indicated data may be changed without notice.
All the measures indicated are expressed in millimeters (mm).

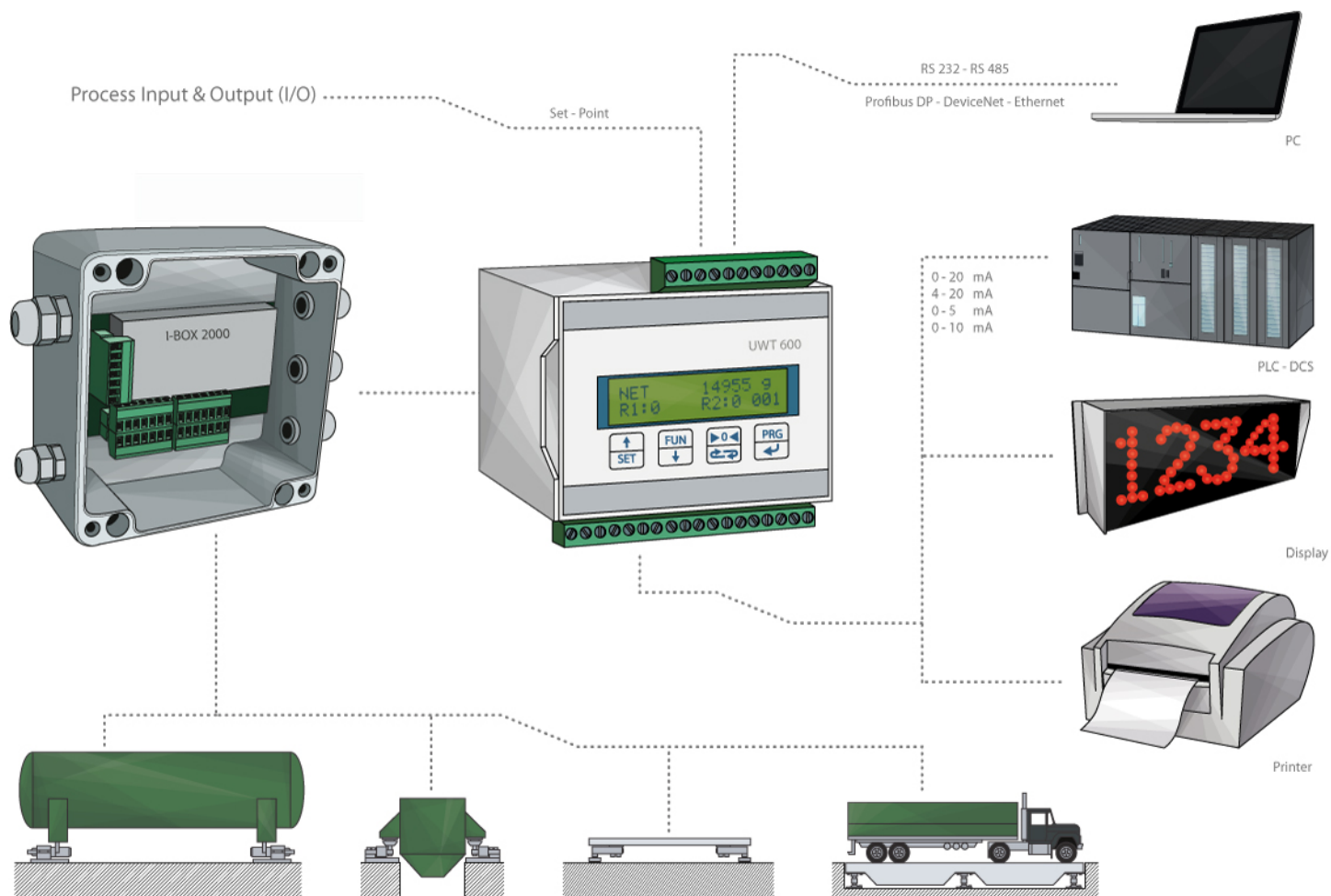

All indicated data may be changed without notice.
All the measures indicated are expressed in millimeters (mm).

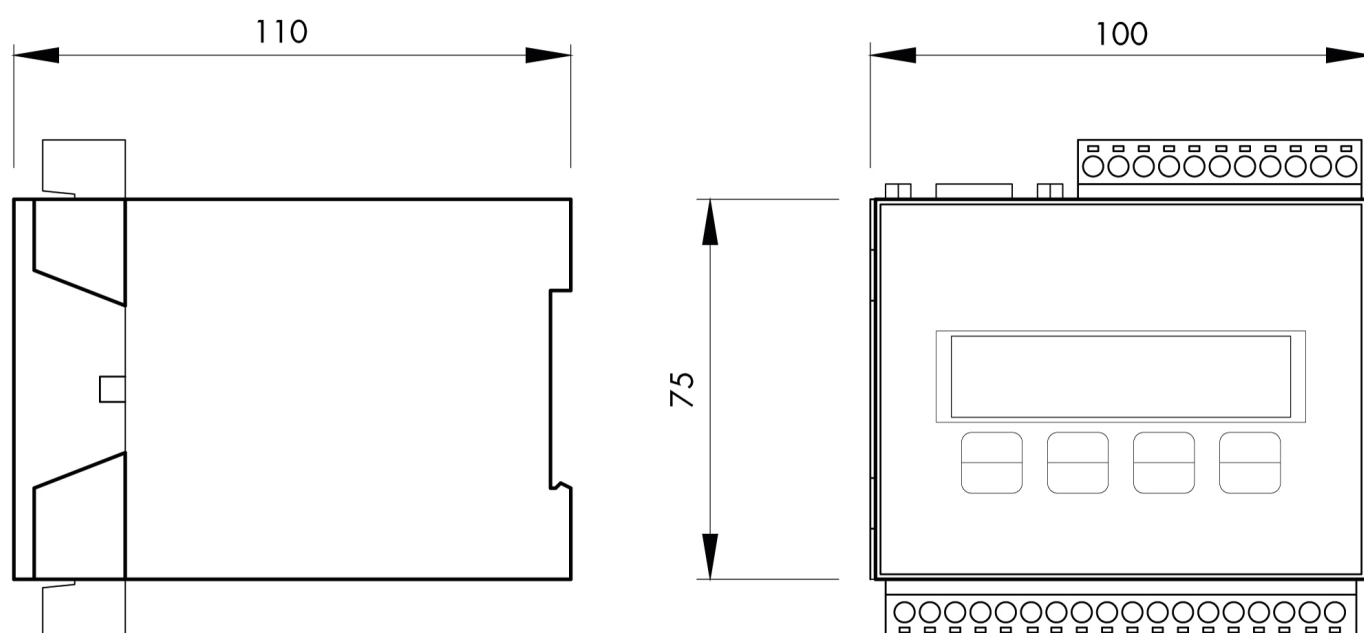

All indicated data may be changed without notice.
All the measures indicated are expressed in millimeters (mm).