

## General information

PVS14220191113

The PSD800 shear beam load cell, made of stainless steel and hermetically sealed, is suitable for platforms, hoppers and pallets. The PSD800 shear beam load cell guarantees high precision up to 6000 divisions and has a 6-meter long cable.



All indicated data may be changed without notice.  
All the measures indicated are expressed in millimeters (mm).

## Technical specifications

PVS14220191113

<b>Rated load RL:</b>	150, 300, 500, 1000, 1500, 2000, 2500, 3000, 5000 Kg
<b>Combined error:</b>	±0.023 % RO
<b>Repeatability:</b>	±0.01 % RO
<b>Creep (30 minutes):</b>	±0.02 % RO
<b>Safe overload:</b>	150 % RL
<b>Ultimate overload:</b>	300 % RL
<b>Material:</b>	Stainless steel
<b>Degree of protection:</b>	IP68
<b>Accuracy class:</b>	3000 OIML (C3), optional: C4, C5, C6
<b>Deflection:</b>	0.2 ÷ 1.4 mm
<b>Compensated Temperature:</b>	-10 ÷ +40 °C
<b>Temperature range:</b>	-18 ÷ +65 °C
<b>Temperature effect on zero balance:</b>	±0.018 % RO/10° C
<b>Temperature effect on output:</b>	±0.012 % output/10° C
<b>Rated output RO:</b>	2.0 ±0.04 mV/V
<b>Zero balance:</b>	±1.0 % RO
<b>Insulation resistance:</b>	> 1000 MOhm
<b>Input resistance:</b>	350 ±3.5 Ohm
<b>Output resistance:</b>	350 ±3.5 Ohm
<b>Recommended input:</b>	5 ÷ 12 Vdc/Vac

All indicated data may be changed without notice.  
 All the measures indicated are expressed in millimeters (mm).

150kg – 300kg (Bending)

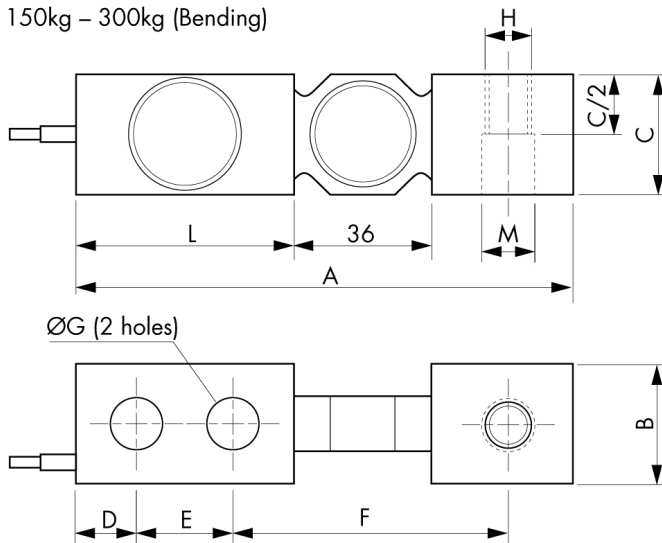

Other capacities (Shear)

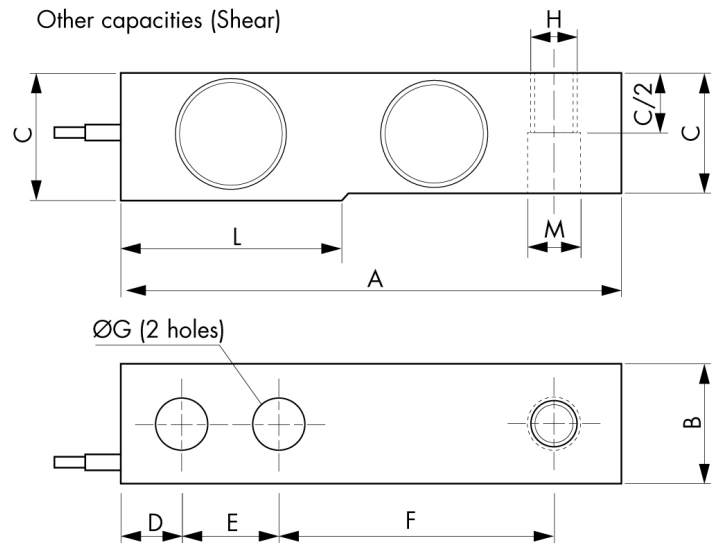

Capacity Kg	A	B	C	c	D	E	F	G	H	L	M
150 - 300	130	31.3	31.3	-	15.7	25.4	76.2	13.5	M12 x 1.75	57.1	13.5
500 - 2000	130	31.3	31.3	* see note	15.7	25.4	76.2	13.5	M12 x 1.75	57.1	13.5
2500 - 5000	171	36.8	36.8	34.8	19	38.1	95.2	20.5	M20 x 2.5	76.2	20.5

\*Note: 500kg 24.8; 1000kg 26.0; 2000kg 28.0

**Electrical Connections**

+Excitation	Red
-Excitation	Black
+Sense	Brown
-Sense	Yellow
+Signal	Blue
-Signal	White
Shield	Cable Shield

\* Sense when available

 All indicated data may be changed without notice.  
 All the measures indicated are expressed in millimeters (mm).